

## CROMWELL Qualfast. 5x36mm METRIC EXTRACTABLE DOWEL PIN C/W AIR FLAT

Cod comanda: **QFT6500238X**

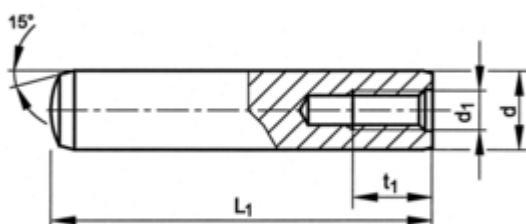

### Descriere produs:

This range of Metric Extractable Dowel Pins with Air Flats are ideal for use when keeping machine components locked together or for aligning purposes. Available in a range of sizes, each component is manufactured from steel and has a plain finish. Features and Benefits o Available in a range of metric sizes to suit your needs o Manufactured from steel for maximum durability and product longevity o 'As produced' oiled finish (black) - Provides some shelf life but no real corrosion protection in use Typical Applications o Engineering o Automotive o Construction Standards o DIN 7979D o NEN 2464 o ISO 8735A

### Detalii tehnice:

#### Dimensiuni ambalaj:

Lungime mm: 0

Latime mm: 0

Inaltime mm: 0

Greutate g: 0

### Set de livrare: